

Thermostatic Steam Trap

Low to Moderate Steam Service
VAC-125 PSIG

PRODUCT FEATURES

- 100% Factory Calibrated & Tested
- Bronze Body, Forged Brass Cover, Union Nut & Tailpiece
- Corrosion Resistant Seat & Stainless Steel Plug
- Pipe Sizes (NPT) 1/2", 3/4" & 1"
- Piping Patterns: Angle, Straight & Vertical
- "Cage Unit" interiors for uniform performance



Model 122A



Cage Unit - 25 PSIG



Cage Unit - 125 PSIG

CAPACITIES (Square Feet EDR)												
Model			Pressure Differential (PSIG)									
Model	Size	Orifice	.25	.50	1	1.5	2	3	5	10	15	25
122 & BJVST-2L	1/2"	5/16"	92	120	168	200	228	278	320	490	610	1270
134 & BJVST-3L	3/4"	5/16"	152	208	320	400	450	512	710	1040	1260	2450
147	1"	1/4"	300	430	590	700	760	824	1200	1750	2200	4100
12A	1/2" x 3/4"	5/16"	92	120	168	200	228	278	320	490	610	1270

Note: For low-pressure heating, thermostatic traps are rated in square feet EDR (Equivalent Direct Radiation). One square foot EDR is equal to 240 BTU per hour or 0.25 lbs. of condensate.

CAPACITIES (LBS. Condensate per hour)															
Model			Pressure Differential (PSIG)												
Model	Size	Orifice	2	3	5	10	15	20	40	50	60	65	80	100	125
EBA & BJVST-2M	1/2" & 3/4"	1/4"	440	550	1150	1540	1700	1910	2370	2960	3260	3430	-	-	-
EA & BJVST-2H	1/2" & 3/4"	1/4"	440	550	1150	1540	1700	1910	2370	2960	3260	3430	3670	4050	4350

Note: Capacities shown are 10° below saturated steam temperature and are the result of an extensive testing program in conducted in accordance with ANSI/ASME PTC 39.1-1980. Condensate Removal Devices for Steam Systems, at the Barnes & Jones factory. Significantly greater capacities are realized when condensate temperatures are cooler than 10° below saturated steam temperature.

Dimensions							
Model	Size	A	B	C	D	E	Wt. (lbs.)
122A	1/2"	3	1 1/4	2 1/2	2 9/16	-	1
134A	3/4"	3 3/8	1 3/8	2 7/8	2 9/16	-	1
147A	1"	3 5/8	1 11/16	3 1/2	3 1/16	-	2 5/8
122S	1/2"	3	2"	2 1/2	2 9/16	1/2	2
134S	3/4"	3 3/8	2 1/8	2 7/8	2 9/16	5/8	1 7/8
12A	1/2"	3	1 1/4	2 1/2	2 9/16	-	1
2EBA, 2EA	1/2"	3	1 1/4	3	2 9/16	-	1 2/3
3EBA, 3EA	3/4"	3 3/8	1 3/8	3 3/8	2 9/16	-	2
2EBS, 2ES	1/2"	3	2	3	2 9/16	1/2	2
3EBS, 3EAS	3/4"	3 3/8	2 1/8	3 3/8	2 9/16	5/8	2 1/4
BJVST	1/2", 3/4"	2 1/4	4 3/4	-	-	-	1 1/3

MATERIALS			
Part	122, 134, BJVST-L	147, EBA, BJVST-M	EA, ES, BJVST-H
Cap	Brass, ASTM CDA-377	Brass, ASTM CDA-377	Brass, ASTM CDA-377
Body	Brass or Bronze	Brass or Bronze	Brass or Bronze
Element	Monel & Phosphor Bronze	Phosphor Bronze	Monel
Gaskets	Non-Asbestos Fiber	Copper	Copper
Plug	Stainless Steel	Bronze	Stainless Steel
Seat	Brass	Brass	Stainless Steel

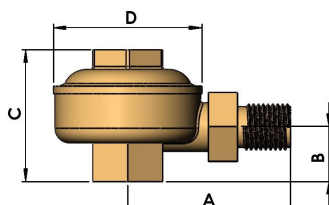

ANGLE

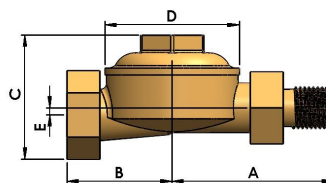

STRAIGHT

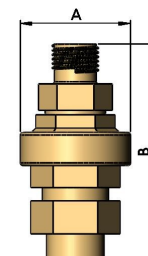

VERTICAL