



Float & Thermostatic Steam Traps

Series 2000 (VAC-125 PSIG)



Product Features

- High quality premium grade components
- Variety of piping combinations “H-Pattern” design
- Responds quickly to changes in condensate load
- Condensate discharge temperature closely follows the saturated steam curve
- Function not impaired by high back pressure
- Energy efficient
- Simple on-line repair
- Meets MIL Spec WWT-696



Sizes 3/4” to 2” NPT

Description

Barnes & Jones Series 2000 Float & Thermostatic steam traps are designed for all types of applications including steam heating, steam process equipment and industrial steam distribution. Typical applications include unit heaters, steam coils water heaters, low-pressure steam mains and risers, steam kettles and high-pressure steam mains and risers.

Float & Thermostatic steam traps are specially well suited for chillers, steam coils, air handling equipment, humidification, high pressure drip traps and more. Please consult the factory for assistance with steam trap selection.

Operation

The opening and closing of the water valve is caused by changes in the condensate level within the body of the steam trap. When the water level drops, the weight of the float closes the water valve. As condensate enters the steam trap body, the float rises and opens the valve, allowing condensate to be discharged. The float is designed to provide sufficient buoyancy to overcome the differential pressure across the valve. The internal float and valve configuration is such that the condensate level is always above the valve, creating a continuous water seal at the seat.

Construction

Barnes & Jones float and thermostatic steam traps are compact, rugged design with easy access to all interior parts. The body is cast with two inlet and two outlet pipe connections (H-pattern) that permit multiple piping options for all types of applications. All working parts are made of stainless steel and are attached to the cover casting. The repair kit consists of a complete, factory assembled head which simply bolts on for ease of repair. No pipe connections need to be broken except for 2” models which are piped through the head.

Part	Material Description
Head/Body	Cast Iron, ASTM-A278 Class 30
Bolting	Steel, Grade 5
Gaskets	Non-Asbestos Fiber
Float	Stainless Steel
Valve Plug	Stainless Steel
Valve Seat	Stainless Steel
Air Vent	Phosphor Bronze / Monel , Thermostatic Element
Air Vent	Stainless Steel Ball, Seat & Housing

Ease of Steam Trap Repair

Factory preassembled repair kits are available for most B&J models and other manufactures F&T traps. Consult the Factory for selections.



RK2015-3 Repair Kit Head Assembly

Engineering Specifications

CAPACITIES (SHEMA) lbs. hot condensate per hour.

Model	Size (NPT)	Orifice	Pressure Differential (PSIG)						
			1/4	1/2	1	2	5	10	15
FT2015-3	3/4"	.203"	70	100	140	200	210	220	230
FT2015-4	1"	.203"	175	250	350	500	525	550	575
FT2015-5	1-1/4"	.312"	425	600	850	1200	1260	1320	1380
FT2015-6	1-1/2"	.500"	850	1200	1700	2400	2520	2640	2760
FT2015-8	2"	.625"	1775	2500	3550	5000	5250	5500	5750

Note: Low pressure F&T trap capacities are in accordance with standards adopted by the Steam Heating Manufacturer's Association (SHEMA) providing for continuous elimination of air when the trap is operating at its maximum rating. No safety factor need be applied. Actual capacities significantly greater than SHEMA ratings indicate.

CAPACITIES (Gross) lbs. hot condensate per hour.

Model	Size (NPT)	Orifice	Pressure Differential (PSIG)																
			1/4	1/2	1	2	5	10	15	20	25	30	40	50	75	100	125		
FT2015-3	3/4"	.203"	293	387	513	683	824	1050	1129	-	-	-	-	-	-	-	-		
FT2015-4	1"	.203"	293	387	513	683	824	1050	1129	-	-	-	-	-	-	-	-		
FT2015-5	1-1/4"	.312"	630	808	1029	1302	1722	2100	2457	-	-	-	-	-	-	-	-		
FT2015-6	1-1/2"	.500"	1155	1785	2520	3465	5250	6930	7980	-	-	-	-	-	-	-	-		
FT2015-8	2"	.625"	2415	2940	3780	4883	7245	9450	11445	-	-	-	-	-	-	-	-		
FT2030-3	3/4"	.203"	293	387	513	683	824	1050	1129	1271	1365	1439	-	-	-	-	-		
FT2030-4	1"	.203"	293	387	513	683	824	1050	1129	1271	1365	1439	-	-	-	-	-		
FT2030-5	1-1/4"	.312"	394	525	725	956	1260	1575	1764	1890	1995	2100	-	-	-	-	-		
FT2030-6	1-1/2"	.437"	1050	1365	1785	2415	3570	4830	5775	6300	6930	7350	-	-	-	-	-		
FT2030-8	2"	.500"	1365	1890	2625	3570	5460	7140	8190	9030	9765	10500	-	-	-	-	-		
FT2075-3	3/4"	.203"	168	224	294	383	546	735	835	919	977	1019	1176	1292	1523	-	-		
FT2075-4	1"	.203"	168	224	294	383	546	735	835	919	977	1019	1176	1292	1523	-	-		
FT2075-5	1-1/4"	.339"	410	578	667	956	1397	1943	2258	2520	2730	2940	3203	3465	3990	-	-		
FT2075-6	1-1/2"	.339"	557	761	1008	1365	1995	2783	3203	3570	3885	4200	4620	4988	5670	-	-		
FT2075-8	2"	.437"	893	1155	1575	2100	3255	4358	4987	5460	5775	6090	6720	7140	8085	-	-		
FT2125-3	3/4"	.125"	105	142	184	242	347	436	525	593	651	698	788	872	1019	1199	1249		
FT2125-4	1"	.125"	105	142	184	242	347	436	525	593	651	698	788	872	1019	1199	1249		
FT2125-5	1-1/4"	.250"	294	389	504	662	956	1260	1523	1733	1864	1995	2179	2363	2783	3098	3308		
FT2125-6	1-1/2"	.250"	420	546	714	935	1365	1785	2153	2415	2625	2835	3150	3360	3990	4410	4725		
FT2125-8	2"	.338"	578	709	924	1286	2048	2730	3150	3413	3675	3990	4410	4850	5775	6405	6930		

Note: Capacities based on continuous discharge at steam temperature. Results in accordance with ANSI/ASME PTC 39.1 Condensate Removal Devices for Steam Systems. Significantly greater capacities are realized when condensate temperature is below saturated steam temperature. Appropriate safety factors should be applied to these ratings. Consult the factory for assistance with trap sizing.

DIMENSIONS (in.)

Size	A	B	C	D	WT
3/4" & 1"	5 11/16	5	3 5/16	5 5/8	11 lbs.
1-1/4"	6 1/8	5 1/2	3	5 3/8	12 lbs.
1-1/2"	8 1/4	6	3	8 1/4	24 lbs.
2"	10	4 7/8	4 7/8	9 1/4	22 lbs.

MAXIMUM OPERATING CONDITONS

PMO (Max. Operating Pressure/Temperature)	PMA (Max. Allowable Pressure / Temperature)
15 psig / 250° F	250 psig / 450° F
30 psig / 274° F	250 psig / 450° F
75 psig / 320° F	250 psig / 450° F
125 psig / 353° F	250 psig / 450° F

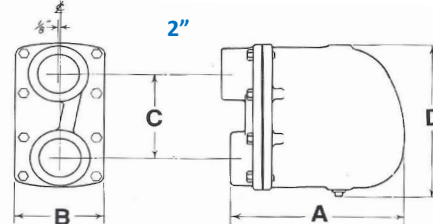
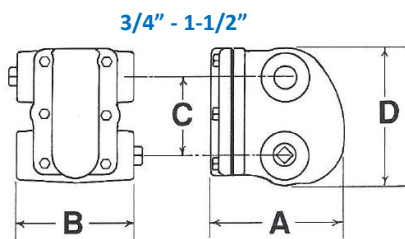

Product Features

- High quality premium grade components
- Variety of piping combinations “H-Pattern” design
- Responds quickly to changes in condensate load
- Condensate discharge temperature closely follows the saturated steam curve
- Function not impaired by high back pressure
- Energy efficient
- Simple on-line repair
- Meets MIL Spec WWT-696



Sizes 3/4" to 2" NPT

Description

Barnes & Jones Series 2000 Float & Thermostatic steam traps are designed for all types of applications including steam heating, steam process equipment and industrial steam distribution. Typical applications include unit heaters, steam coils water heaters, low-pressure steam mains and risers, steam kettles and high-pressure steam mains and risers.

Float & Thermostatic steam traps are specially well suited for chillers, steam coils, air handling equipment, humidification, high pressure drip traps and more. Please consult the factory for assistance with steam trap selection.

Operation

The opening and closing of the water valve is caused by changes in the condensate level within the body of the steam trap. When the water level drops, the weight of the float closes the water valve. As condensate enters the steam trap body, the float rises and opens the valve, allowing condensate to be discharged. The float is designed to provide sufficient buoyancy to overcome the differential pressure across the valve. The internal float and valve configuration is such that the condensate level is always above the valve, creating a continuous water seal at the seat.

Construction

Barnes & Jones float and thermostatic steam traps are compact, rugged design with easy access to all interior parts. The body is cast with two inlet and two outlet pipe connections (H-pattern) that permit multiple piping options for all types of applications. All working parts are made of stainless steel and are attached to the cover casting. The repair kit consists of a complete, factory assembled head which simply bolts on for ease of repair. No pipe connections need to be broken except for 2" models which are piped through the head.

Part	Material Description
Head/Body	Cast Iron, ASTM-A278 Class 30
Bolting	Steel, Grade 5
Gaskets	Non-Asbestos Fiber
Float	Stainless Steel
Valve Plug	Stainless Steel
Valve Seat	Stainless Steel
Air Vent	Phosphor Bronze, Calibrated Thermostatic Element
Air Vent	Stainless Steel Ball, Seat & Housing

Ease of Steam Trap Repair

Factory preassembled repair kits are available for most B&J models and other manufactures F&T traps. Consult the Factory for selections.



RK2015-3 Repair Kit Head Assembly

Engineering Specifications

CAPACITIES (SHEMA) lbs. hot condensate per hour.

Model	Size (NPT)	Orifice	Pressure Differential (PSIG)						
			1/4	1/2	1	2	5	10	15
FTI2015-3	3/4"	.203"	70	100	140	200	210	220	230
FTI2015-4	1"	.203"	175	250	350	500	525	550	575
FTI2015-5	1-1/4"	.312"	425	600	850	1200	1260	1320	1380
FTI2015-6	1-1/2"	.500"	850	1200	1700	2400	2520	2640	2760
FTI2015-8	2"	.625"	1775	2500	3550	5000	5250	5500	5750

Note: Low pressure F&T trap capacities are in accordance with standards adopted by the Steam Heating Manufacturer's Association (SHEMA) providing for continuous elimination of air when the trap is operating at its maximum rating. No safety factor need be applied. Actual capacities significantly greater than SHEMA ratings indicate.

CAPACITIES (Gross) lbs. hot condensate per hour.

Model	Size (NPT)	Orifice	Pressure Differential (PSIG)															
			1/4	1/2	1	2	5	10	15	20	25	30	40	50	75	100	125	
FTI2015-3	3/4"	.203"	293	387	513	683	824	1050	1129	-	-	-	-	-	-	-	-	
FTI2015-4	1"	.203"	293	387	513	683	824	1050	1129	-	-	-	-	-	-	-	-	
FTI2015-5	1-1/4"	.312"	630	808	1029	1302	1722	2100	2457	-	-	-	-	-	-	-	-	
FTI2015-6	1-1/2"	.500"	1155	1785	2520	3465	5250	6930	7980	-	-	-	-	-	-	-	-	
FTI2015-8	2"	.625"	2415	2940	3780	4883	7245	9450	11445	-	-	-	-	-	-	-	-	
FTI2030-3	3/4"	.203"	293	387	513	683	824	1050	1129	1271	1365	1439	-	-	-	-	-	
FTI2030-4	1"	.203"	293	387	513	683	824	1050	1129	1271	1365	1439	-	-	-	-	-	
FTI2030-5	1-1/4"	.312"	394	525	725	956	1260	1575	1764	1890	1995	2100	-	-	-	-	-	
FTI2030-6	1-1/2"	.437"	1050	1365	1785	2415	3570	4830	5775	6300	6930	7350	-	-	-	-	-	
FTI2030-8	2"	.500"	1365	1890	2625	3570	5460	7140	8190	9030	9765	10500	-	-	-	-	-	
FTI2075-3	3/4"	.203"	168	224	294	383	546	735	835	919	977	1019	1176	1292	1523	-	-	
FTI2075-4	1"	.203"	168	224	294	383	546	735	835	919	977	1019	1176	1292	1523	-	-	
FTI2075-5	1-1/4"	.339"	410	578	667	956	1397	1943	2258	2520	2730	2940	3203	3465	3990	-	-	
FTI2075-6	1-1/2"	.339"	557	761	1008	1365	1995	2783	3203	3570	3885	4200	4620	4988	5670	-	-	
FTI2075-8	2"	.437"	893	1155	1575	2100	3255	4358	4987	5460	5775	6090	6720	7140	8085	-	-	
FTI2125-3	3/4"	.125"	105	142	184	242	347	436	525	593	651	698	788	872	1019	1199	1249	
FTI2125-4	1"	.125"	105	142	184	242	347	436	525	593	651	698	788	872	1019	1199	1249	
FTI2125-5	1-1/4"	.250"	294	389	504	662	956	1260	1523	1733	1864	1995	2179	2363	2783	3098	3308	
FTI2125-6	1-1/2"	.250"	420	546	714	935	1365	1785	2153	2415	2625	2835	3150	3360	3990	4410	4725	
FTI2125-8	2"	.338"	578	709	924	1286	2048	2730	3150	3413	3675	3990	4410	4850	5775	6405	6930	

Note: Capacities based on continuous discharge at steam temperature. Results in accordance with ANSI/ASME PTC 39.1 Condensate Removal Devices for Steam Systems. Significantly greater capacities are realized when condensate temperature is below saturated steam temperature. Appropriate safety factors should be applied to these ratings. Consult the factory for assistance with trap sizing.

DIMENSIONS (in.)

Size	PSI Rating	A	B	C	Wt.
1/2", 3/4", 1"	15, 30, 75, 125	5.0"	6.25"	6.5"	11 lbs.
1-1/4"	15, 30,	5.0"	6.25"	6.5"	11 lbs.

DIMENSIONS (in.)

Size	PSI Rating	A	B	C	Wt.
1-1/2" & 2"	15, 30	7.5"	10.5"	11.5"	48 lbs.
1-1/4", 1-1/2" & 2"	75, 125	7.5"	10.5"	11.5"	48 lbs.

